

YASKAWA

MOTOMAN MH180

Handling & General Applications with the MH-series

The 6-axis MOTOMAN MH180 is a versatile, high speed robot offering superior performance for a variety of applications, like material handling, machine and press tending.

Despite of providing a high payload of 180 kg and the wide motion range of 2702 mm, the MOTOMAN MH180 was designed with a width of 625 mm, therefore valuable floor space can be saved. With the higher axis operation speed and speed reducer rigidity, a new vibration control system was developed. By reducing cycle times, this system realises high increases in productivity.



KEY BENEFITS

- Fast, flexible and powerful
- High payload: 180 kg
- Wide motion range: 2702 mm
- Maximum performance using minimal floor space

Controlled by
DX200

MOTOMAN MH180

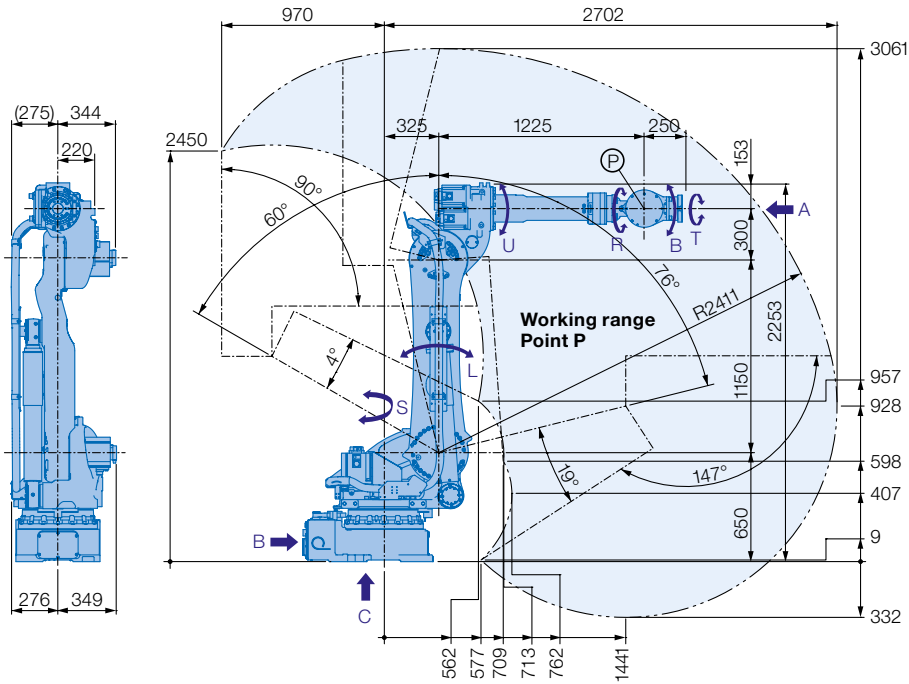

Please note wall mounting option: +/- 30° S-axis limit

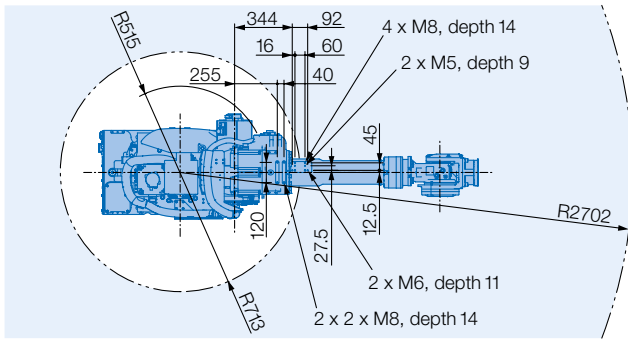

Allowable wrist load

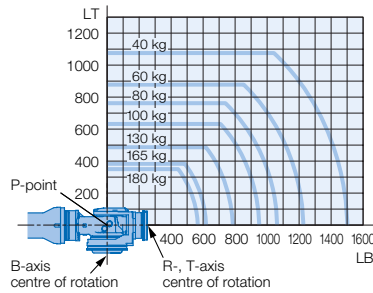

View A

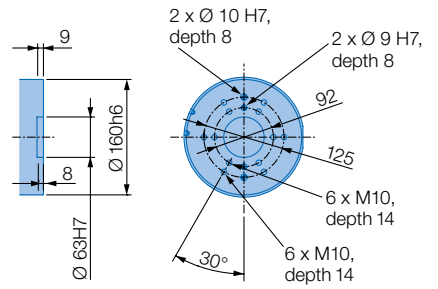

View B

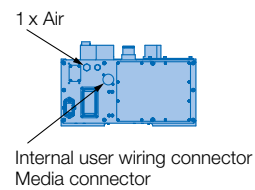

View C

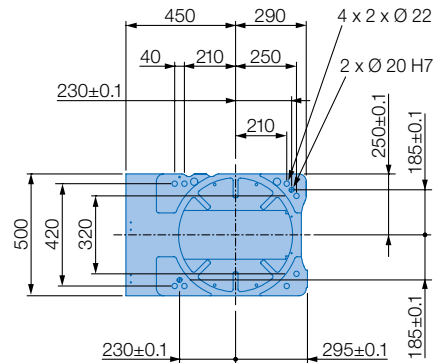

Mounting option: Floor, wall

All dimensions in mm | Technical data may be subject to change without previous notice | Please request detailed drawings at robotics@yaskawa.eu.com - YR-MH00180-A00, C-12-2015, A-No. 167069

Specifications MH180

Axes	Maximum motion range [°]	Maximum speed [°/sec.]	Allowable moment [Nm]	Allowable moment of inertia [kg · m ²]	Controlled axes	
					Max. payload [kg]	
S	±180	125	-	-	Repeat. pos. accuracy [mm]	±0.2
L	+76/-60	115	-	-	Max. working range R [mm]	2702
U	+90/-147	125	-	-	Temperature [°C]	0 to +45
R	±360	182	1000	90	Humidity [%]	20 - 80
B	±130	175	1000	90	Weight [kg]	970
T	±360	265	618	46.3	Power supply, average [KVA]	5.0

YASKAWA

robotics@yaskawa.eu.com
www.yaskawa.eu.com

YASKAWA Headquarters

YASKAWA Europe GmbH · Robotics Division
Yaskawastraße 1 · D-85391 Allershausen
Tel. +49 (0) 8166/90-0 · Fax +49 (0) 8166/90-103

YASKAWA academy and sales office Frankfurt

YASKAWA Europe GmbH · Robotics Division
Hauptstraße 185 · D-65760 Eschborn
Tel. +49 (0) 6196/77725-0 · Fax +49 (0) 6196/77725-39